

ORION®

INSTRUCTION MANUAL

Cooler and Warmer

ENGLISH

ENG

**Model:
ORION CF-160G**



Please, read this manual carefully, before use.

Store this instruction manual in a safe place.

ORION®

Dear Customers!
Thank you for buying cooler/warmer ORION!

We surely believe you will get a lot of pleasure using this device for many years!

Please read these manual before use.
It easily describes and explains how to use
all functions in understanding way.

CONTENTS

SAFETY PRECAUTIONS	3
FEATURE	4
SET UP	4
OPERATION	4
USING THE COOLER/WARMER.....	5
MAINTENANCE	5
FUSE BLOWOUT.....	6
TECHNICAL DATA	6
TROUBLESHOOTING.....	6
COMPLETION.....	6

SAFETY PRECAUTIONS

1. Do not touch the inside of the unit during use or for 30 minutes after use, as it may cause severe burns.
2. Do not carry the cooler by the cable or pull the cable to remove the plug from the socket.
3. Inspect the cooler cable and any extension leads used periodically for excessive wear or damage.
4. Operate the unit only with the cord provided. Store the cord inside of the unit to prevent loss of cord.
5. Do not hold the plug with wet or moist hands.
6. Be sure that the unit is unplugged prior to starting the vehicle.
Appliance may only be plugged in after the vehicle is running.
Please note that voltage surge may damage the unit.
7. Be sure that the unit is operated in a well ventilated area. Good ventilation is essential to avoid over-heating. The inside element may be damaged and lose its power if the unit is operated in badly ventilated area.
8. Do not cover the vents on the unit.
9. Do not place the unit in a sealed car or in a trunk. Do not obstruct the air flow. Do not use the unit in a closed room without supply of air.
10. Only operate the unit from a 12V DC and 220V AC power source. Do not attempt to operate the unit from any other power source.
11. Do not put any sticks into the fan during operation. Avoid use on grassland since grass can easily get into the fan.
12. Do not touch the terminals of the cigarette plug immediately after use. Touching the plug immediately after use may cause personal injury.
13. Do not use ice or ice packs in this cooler. Water melting from ice/ ice packs may damage the fan motor or create frost build-up on the inside components.
14. Appliance is suitable for camping use. However, unit should not be exposed to rain or moisture.
15. Do not use abrasive cleaners or scrubs as this may damage the unit.
16. Do not immerse the appliance or the 12V plug in water.
17. Do not use household chemicals to clean the unit (e.g. Bleach, etc....).
18. Do not open your cooler/warmer. There are no serviceable parts in this unit. Doing so will void the warranty.
19. This appliance is not intended for use by persons (including children) with reduced physical, sensory or mental capabilities, or lack of experience and knowledge, unless they have been given supervision or instruction concerning use of the appliance by a person responsible for their safety.
Children should be supervised to ensure that they do not play with the appliance.
20. If the cord is damaged it must be replaced by the manufacturer or its Technical Assistance Service or by a person with similar professional training in order to avoid any possible risk.

FEATURE

This cooler/warmer is designed to keep your food and drinks cool or warm during your travels, please note it is not designed to freeze or cook food. Depending on the operating conditions the unit will cool up to 18 degrees below ambient temperature and heat up to 50-65 degrees. The 12V power cable can be plugged into the cigarette lighter socket in your car, boat or caravan. The cooler/warmer is also suitable for camping use however it should not be exposed to any rain, moisture, dirt, dust or sand.

SET UP

Mounting the unit: Assemble the seat belt strap to the unit as per the following diagram.

1. Put the belt through the 2 holes on the housing, as shown on ① and ②

2. Set the belt as shown in ③ and ④ with the belt through the buckle follow the arrows.

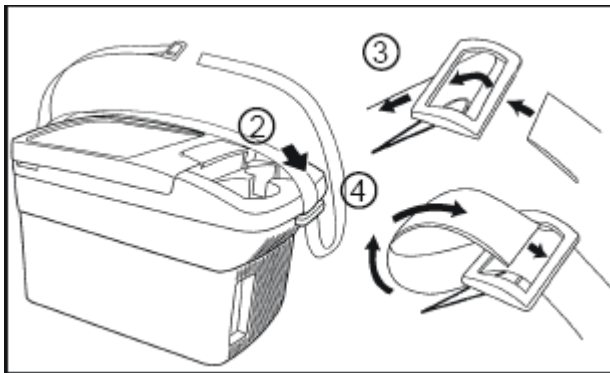

3. Pull the belt at both ends and ensure it is safely set.

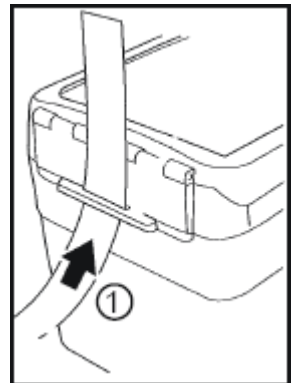

Use the seat belt strap to securely fasten the unit inside your car, boat or caravan.

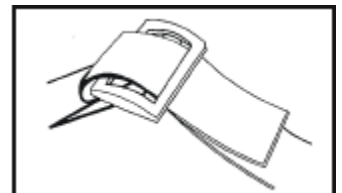

Ensure the unit is mounted so that it is in a secure position and cannot easily fall in the case of car braking etc. Also ensure it is away from direct sunlight.

Connecting of the power cable: Simply plug the 12V cable into the lighter socket in your car, boat or caravan.

OPERATION

Before starting your new cooler for the time, first you should clean it inside and outside with a damp cloth for hygienic reasons. Never use an abrasive product to clean the cooler.

It is recommended for best cooling and warming results to pre-cool or heat the contents before use.

Caution: Ensure the car engine is switched on before you connect the 12V power cable to avoid power surges which will potentially damage the warmer/cooler. It is strongly

recommended that the appliance is used in conjunction with a surge protection device to protect the electronic components inside.

USING THE COOLER/WARMER

Once connected to a 12V power source turn on the unit by switching it to either “hot” or “cold”. When switching between cold and hot functions ensure to wait 5 to 10 minutes for the unit to return to ambient temperature. When turning off the appliance ensure to switch to off position before removing the 12V power cable.

HEATING

When in hot mode the red LED light will be on. The cooler is designed for the purpose of keeping warm food warm and not for warming up cold food. It will of course, also warm up cold food providing it is allowed sufficient time to do so. Hot meals also stay hot for a number of hours after the equipment is switched off providing the lid is properly closed.

Caution: DO NOT TOUCH the inside of the unit during use or for 30 minutes after use, as it may cause severe burns. Be sure to supervise children when the unit is in operation.

COOLING

When in cold mode the green LED light will be on. The best affect is achieved when you fill your cooler with food and beverages which are already refrigerated. They will then stay cool and even become cooler still providing the appliance remains switched on. If you wish to cool perishable medicines please check if the cooling capacity of the device is suitable for the medicine in question.

Caution: DO NOT use ice or ice packs in this cooler. Water melting from ice/ice packs may damage the fan motor or create frost build-up on the inside components.

The cooling/warming temperature will be influenced by:

- The ambient temperature.
- Amount of food to be conserved.
- The frequency in which the lid is opened.

Ventilation

Ensure the cooler/warmer is in a well ventilated area and avoid blocking or interfering with the flow of air to the fan. Never use the cooler/warmer in a closed room or car boot.

MAINTENANCE

Before cleaning the cooler/warmer disconnect the 12V power cable. Clean the cooler/warmer on a regular bases with warm water containing a detergent if necessary. Dry the clean surface with a soft damp cloth.

Do not clean the cooler under running water, or immerse in water. Do not use abrasive cleaning agents or hard objects during cleaning as this will

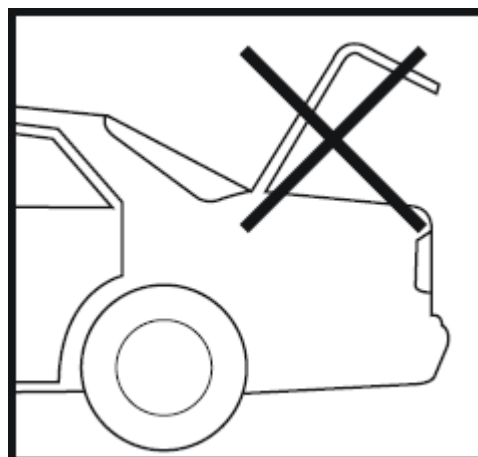

damage the cooler.

FUSE BLOWOUT

Replace the broken fuse with the attached spare fuse by completing the following steps:

- 1) Pull out the plastic cap by removing the screw using a screwdriver.
- 2) Remove the blown fuse and replace with the new fuse.
- 3) Fasten the screw and put the plastic cap in place.

TECHNICAL DATA

Capacity: 16L

Weight: 3.2kg

Application: 12V DC, 220-240V AC, ~50Hz

Rated current: 6A

Power input: 46W (cool)/ 41W (warm)

Cooling capacity: Max 17-23 degrees below ambient temperature

Heating capacity: Max 50-65degrees

Insulation: Solid polyurethane foam

Cooling unit: Thermo electric element

TROUBLESHOOTING

If the unit does not operate correctly:

1. Make sure that the contacts in the 12V socket are clean.
2. Make sure the 12V plug is properly connected in the 12V power source.
3. Make sure there are no obstructions in or near the fan that may affect its operation.
4. Make sure the unit is well ventilated and not stored in a closed area such as a car boot.

COMPLETION

Cooler and Warmer, Auto adapter 12V, Adapter 220V/12V (optional), User Manual, Warranty Card

Note: DOES NOT CONTAIN HAZARDOUS SUBSTANCES

Subject to change without notice

Extra information you can find on ORION company web-site www.orion.ua

If you have any questions or suggestions, contact us by E-mail support@orion.ua

MANUFACTURER: ORION CHINA LTD., 1733 LIANHUA ST., APT. 506-509,
SHANGHAI, PEOPLE'S REPUBLIC OF CHINA, 201103

MADE TO ORDER: ORION ELECTRONICS LTD. (HUNGARY)

